



## SSC8048GT8

### N-Channel Enhancement Mode MOSFET

#### ➤ Features

V <sub>DS</sub>	V <sub>GS</sub>	R <sub>DS(ON)</sub> Typ.	I <sub>D</sub>
40V	±20V	6.6mΩ@10V	60A
		8.2mΩ@4V5	

#### ➤ Description

This device is N-Channel enhancement MOSFET. Uses advanced trench technology and design to provide excellent RDSON with low gate charge. This device is suitable for use in DC-DC conversion, power switch and charging circuit.

**100% UIS + ΔVDS + Rg Tested!**

#### ➤ Applications

- Motor Drive Control
- Portable Devices
- DCDC Conversion
- Power Supplies
- Synchronous Rectification

#### ➤ Ordering Information

Device	Package	Shipping
SSC8048GT8	TO-252-2L	2500/Reel

#### ➤ Pin Configuration

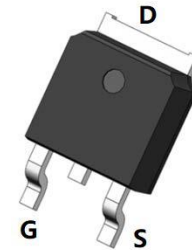

**TO-252-2L (Top View)**

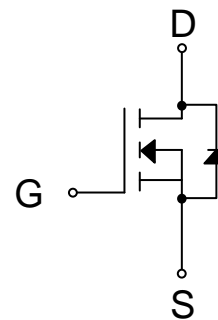

**Pin Configuration**

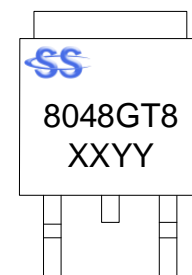

**Marking**

(XXYY: Internal Traceability Code)



## ➤ Absolute Maximum Ratings ( $T_A=25^{\circ}\text{C}$ unless otherwise noted)

Symbol	Parameter	Ratings	Unit
$V_{DSS}$	Drain-to-Source Voltage	40	V
$V_{GSS}$	Gate-to-Source Voltage	$\pm 20$	V
$I_D$	Continuous Drain Current <sup>d</sup>	$T_C=25^{\circ}\text{C}$	60
		$T_C=100^{\circ}\text{C}$	35
$I_{DSM}$	Continuous Drain Current <sup>a</sup>	$T_A=25^{\circ}\text{C}$	18
		$T_A=70^{\circ}\text{C}$	13
$I_{DM}$	Pulsed Drain Current <sup>b</sup>	240	A
$P_D$	Power Dissipation <sup>c</sup>	$T_C=25^{\circ}\text{C}$	62.5
		$T_C=100^{\circ}\text{C}$	25
$P_{DSM}$	Power Dissipation <sup>a</sup>	$T_A=25^{\circ}\text{C}$	4.2
		$T_A=70^{\circ}\text{C}$	2.7
$I_{AS}$	Avalanche Energy <sup>b</sup> L=0.5mH Single Pulse	20	A
$E_{AS}$	Avalanche Energy <sup>b</sup> L=0.5mH Single Pulse	100	mJ
$T_J$	Operation junction temperature	-55~150	$^{\circ}\text{C}$
$T_{STG}$	Storage temperature range	-55~150	

## ➤ Thermal Resistance Ratings ( $T_A=25^{\circ}\text{C}$ unless otherwise noted)

Symbol	Parameter	Ratings	Unit
$R_{\theta JA}$	Junction-to-Ambient Thermal Resistance <sup>a</sup>	30	$^{\circ}\text{C}/\text{W}$
$R_{\theta JC}$	Junction-to-Case Thermal Resistance	2	

Note:

- The value of  $R_{\theta JA}$  is measured with the device mounted on 1 in<sup>2</sup> FR-4 board with 2oz.copper, in a still air environment with  $T_A=25^{\circ}\text{C}$ . The value in any given application depends on the user is specific board design. The power dissipation is based on the  $t \leq 10\text{s}$  thermal resistance rating.
- Repetitive rating, pulse width limited by junction temperature.
- The power dissipation  $P_D$  is based on  $T_{J(MAX)}=150^{\circ}\text{C}$ , using junction-to-case thermal resistance, and is more useful in setting the upper dissipation limit for cases where additional heat sinking is used.
- The maximum current rating is package limited.



➤ **Electrical Characteristics (T<sub>A</sub>=25°C unless otherwise noted)**

Parameter	Symbol	Test Conditions	Min.	Typ.	Max.	Unit
Drain-Source Breakdown Voltage	V <sub>(BR)DSS</sub>	V <sub>GS</sub> = 0V, I <sub>D</sub> = 250μA	40			V
Gate Threshold Voltage	V <sub>GS(th)</sub>	V <sub>DS</sub> = V <sub>GS</sub> , I <sub>D</sub> = 250uA	1	1.5	2.5	V
Drain-Source On-Resistance	R <sub>DS(on)</sub>	V <sub>GS</sub> = 10V, I <sub>D</sub> = 30A		6.6	8.5	mΩ
		V <sub>GS</sub> = 4.5V, I <sub>D</sub> = 20A		8.2	10.6	
Zero Gate Voltage Drain Current	I <sub>DSS</sub>	V <sub>DS</sub> = 40V, V <sub>GS</sub> = 0V			1	μA
Gate-Source Leak Current	I <sub>GSS</sub>	V <sub>GS</sub> = ±20V, V <sub>DS</sub> = 0V			±100	nA
Forward Voltage	V <sub>SD</sub>	V <sub>GS</sub> = 0V, I <sub>S</sub> = 20A			1.3	V
Input Capacitance	C <sub>ISS</sub>	V <sub>DS</sub> = 20V, V <sub>GS</sub> = 0V, f = 1MHz		2400		pF
Output Capacitance	C <sub>OSS</sub>			160		
Reverse Transfer Capacitance	C <sub>RSS</sub>			146		
Total Gate Charge	Q <sub>G</sub>	V <sub>GS</sub> = 10V, V <sub>DS</sub> = 20V, I <sub>D</sub> = 20A		47		nC
Gate to Source Charge	Q <sub>GS</sub>			9		
Gate to Drain Charge	Q <sub>GD</sub>			10		
Turn-on Delay Time	T <sub>D(ON)</sub>	V <sub>GS</sub> = 10V, V <sub>DS</sub> = 20V, I <sub>D</sub> = 20A, R <sub>G</sub> = 3Ω		10		ns
Rise Time	T <sub>r</sub>			26		
Turn-off Delay Time	T <sub>D(OFF)</sub>			39		
Fall Time	T <sub>f</sub>			7		
Diode Recovery Time	T <sub>rr</sub>	I <sub>F</sub> =20A, di/dt=100A/us		11		ns
Diode Recovery Charge	Q <sub>rr</sub>	I <sub>F</sub> =20A, di/dt=100A/us		4		nC



➤ **Typical Performance Characteristics ( $T_A=25^\circ\text{C}$  unless otherwise noted)**

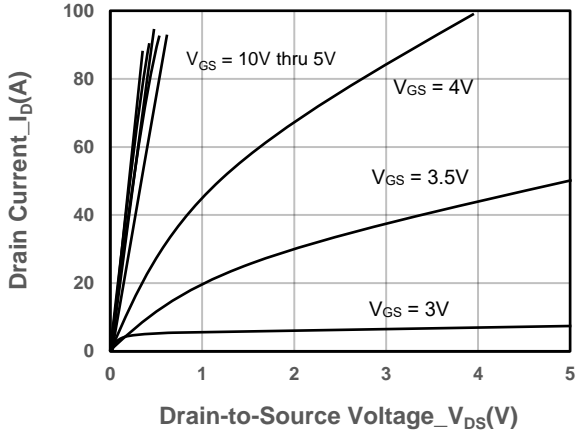

**Output Characteristics**

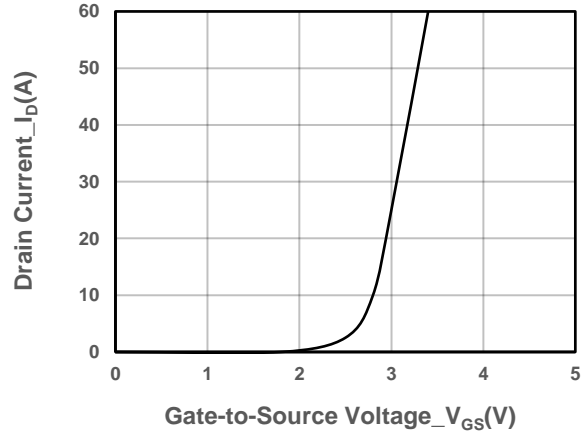

**Transfer Characteristics**

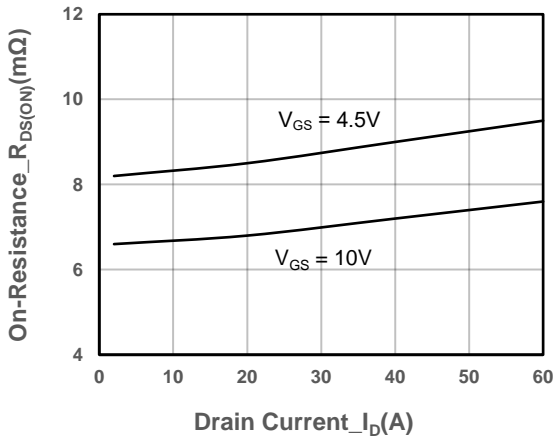

**On-Resistance vs. Drain Current and Gate Voltage**

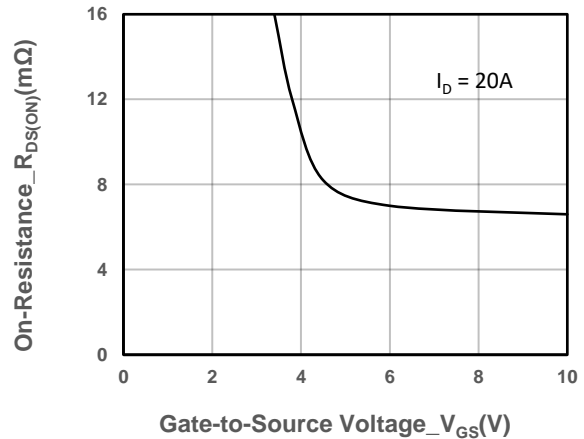

**On-Resistance vs. Gate-to-Source Voltage**

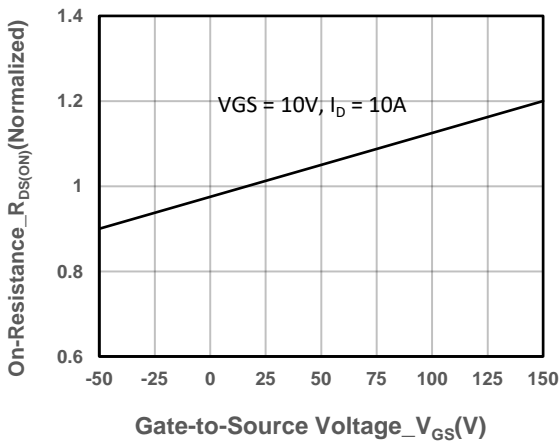

**On-Resistance vs. Junction Temperature**

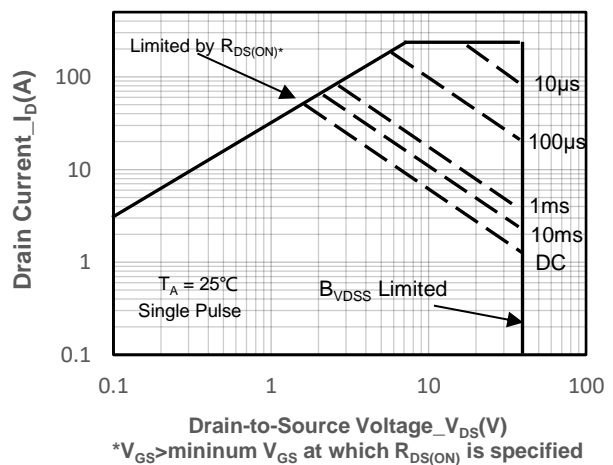

**Safe Operating Area vs. Junction-to-Ambient**



➤ **Package Information**

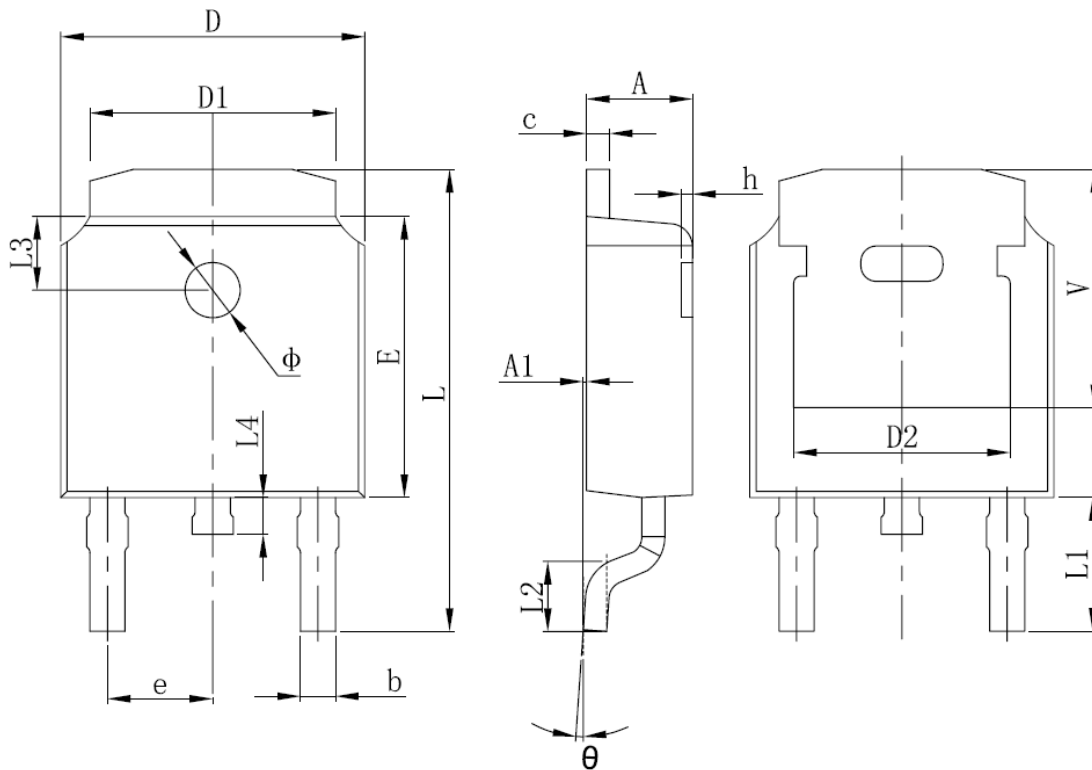

Symbol	Dimensions In Millimeters		Dimensions In Inches	
	Min.	Max.	Min.	Max.
A	2.200	2.400	0.087	0.094
A1	0.000	0.127	0.000	0.005
b	0.635	0.770	0.025	0.030
c	0.460	0.580	0.018	0.023
D	6.500	6.700	0.256	0.264
D1	5.100	5.460	0.201	0.215
D2	4.830 REF.		0.190 REF.	
E	6.000	6.200	0.236	0.244
e	2.186	2.386	0.086	0.094
L	9.712	10.312	0.382	0.406
L1	2.900 REF.		0.114 REF.	
L2	1.400	1.700	0.055	0.067
L3	1.600 REF.		0.063 REF.	
L4	0.600	1.000	0.024	0.039
Φ	1.100	1.300	0.043	0.051
θ	0°	8°	0°	8°
h	0.000	0.300	0.000	0.012
V	5.250 REF.		0.207 REF.	



## DISCLAIMER

SSCSEMI RESERVES THE RIGHT TO MAKE CHANGES WITHOUT FURTHER NOTICE TO ANY PRODUCTS HEREIN TO IMPROVE RELIABILITY, FUNCTION OR DESIGN. SSCSEMI DOES NOT ASSUME ANY LIABILITY ARISING OUT OF THE APPLICATION OR USE OF ANY PRODUCT OR CIRCUIT DESCRIBED HEREIN; NEITHER DOES IT CONVEY ANY LICIENCE UNDER ITS PATENT RIGHTS, NOR THE RIGHTS OF OTHERS.

THE GRAPHS PROVIDED IN THIS DOCUMENT ARE STATISTICAL SUMMARIES BASED ON A LIMITED NUMBER OF SAMPLES AND ARE PROVIDED FOR INFORMATIONAL PURPOSE ONLY. THE PERFORMANCE CHARACTERISTICS LISTED IN THEM ARE NOT TESTED OR GUARANTEED. IN SOME GRAPHS, THE DATA PRESENTED MAY BE OUTSIDE THE SPECIFIED OPERATING RANGE (E.G. OUTSIDE SPECIFIED POWER SUPPLY RANGE) AND THEREFORE OUTSIDE THE WARRANTED RANGE.

OUR PRODUCT SPECIFICATIONS ARE ONLY VALID IF OBTAINED THROUGH THE COMPANY'S OFFICIAL WEBSITE, CRM SYSTEM, OR OUR SALES PERSONNEL CHANNELS. IF CHANGES OR SPECIAL VERSIONS ARE INVOLVED, THEY MUST BE STAMPED WITH A QUALITY SEAL AND MARKED WITH A SPECIAL VERSION NUMBER TO BE VALID.